

Note, you will observe the quantity exceeds the expectations of the Honorable Board - it is owing to a small vacancy that had been left at Gilpin's Gum Corner & as it lay contiguous to Hammond & not to the other I have taken it in.  
 D: B: E: S: G  
 A M: Clean.

11<sup>th</sup> May 1790.

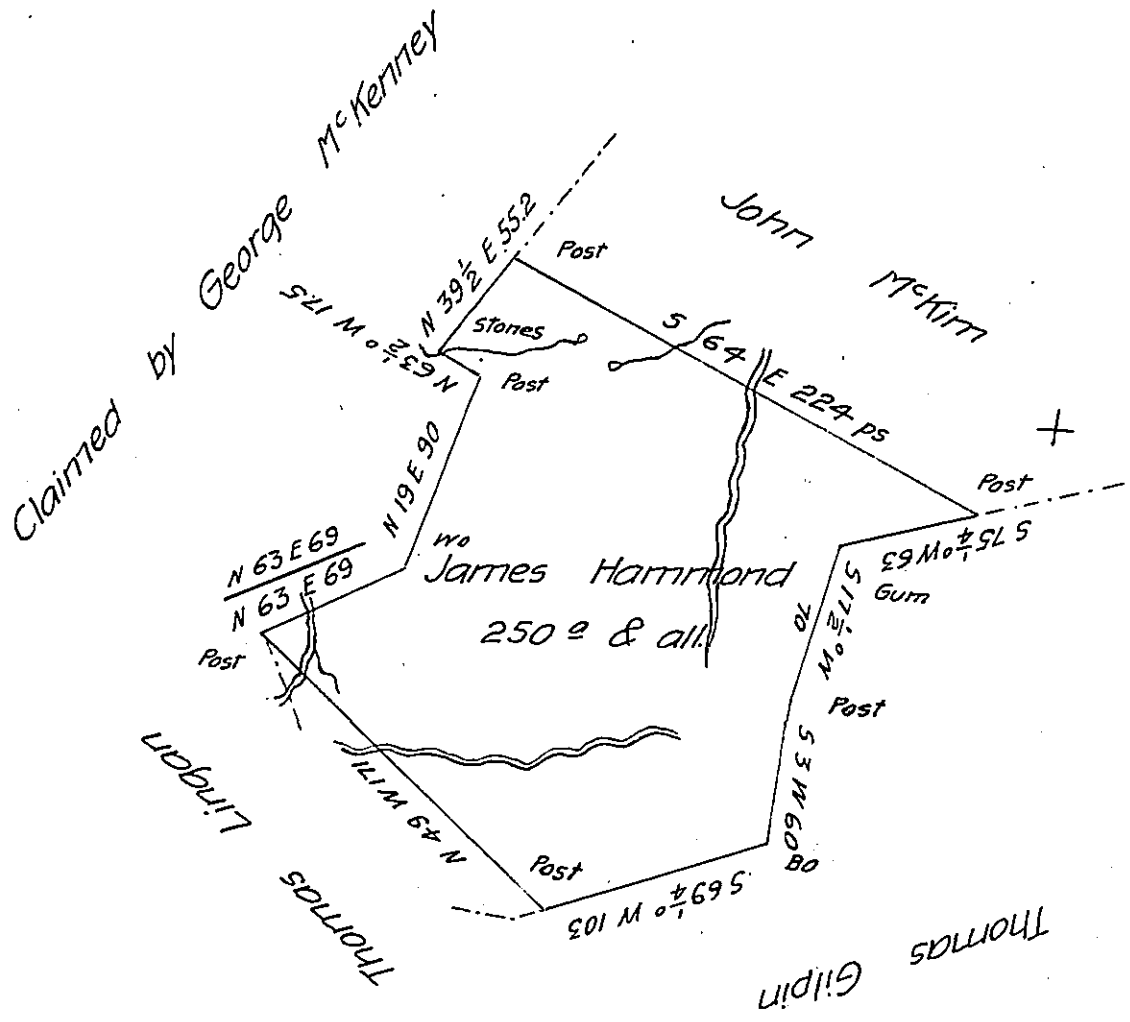

Situate on the Waters of Rushy Run in Luzerne Township Fayette County & resurveyed in part the 31<sup>st</sup> day of March 1790 in consequence of a Decree of the Honorable Board of Property dated 2<sup>d</sup> March 1790.

Daniel Brodhead Esquire

pe-

Surveyor General.

Alexander M: Clean Deputy -

IN TESTIMONY that the above is a copy of the original remaining on file in the Department of Internal Affairs of Pennsylvania, made conformably to an Act of Assembly approved the 16th day of February, 1833, I have hereunto set my Hand and caused the Seal of said Department to be affixed at Harrisburg, this twenty-sixth day of April 1905.

*Joseph P. Pearson*  
 Secretary of Internal Affairs.